

42-0530 R and R parking brake shoes

Preliminary work:
Remove, install brake discs (42-0228).

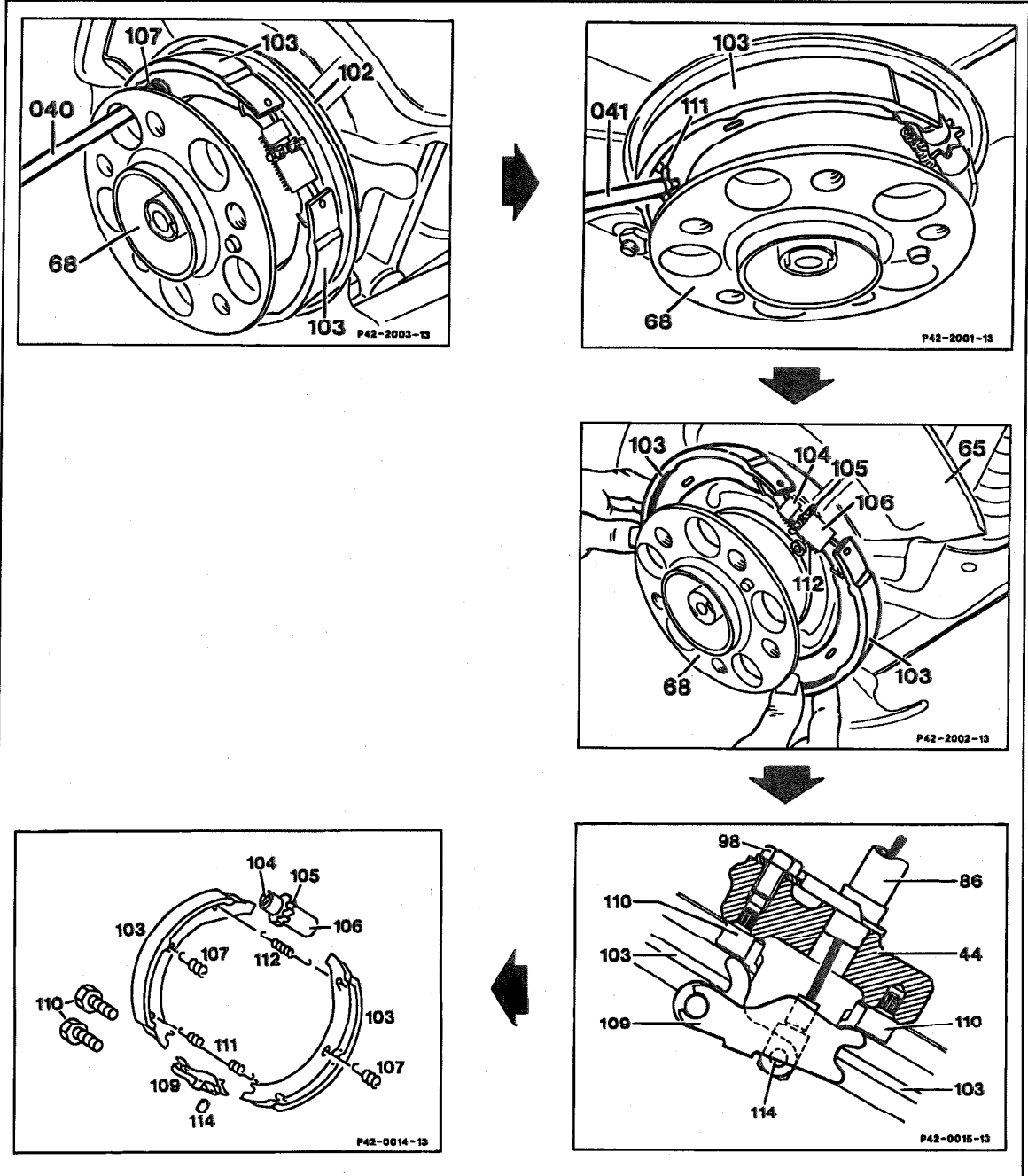

42-0530 R and R parking brake shoes

Rear axle shaft flange (68)	turn so that one hole points to spring (107).
Pressure spring (107)	press together slightly with installation tool (040) 112 589 09 61 00, turn tool approx. 90° and unhook spring from cover ring (102) and remove. Remove spring on other brake shoe in same manner. Assure that springs are correctly seated when installing.
Return spring (111)	unhook from brake shoe (103) with removal and installation tool (041) 116 589 01 62 00. When installing install spring (111) in small eye in brake shoes.
Brake shoes (103)	pull apart until they can be removed over the rear axle shaft flange (68). During installation install adjusting device (104-106) in both brake shoes so that adjusting wheel (105) points toward the front, on vehicles with anti-squat control downward.
Return spring (112)	unhook from brake shoes (103) and remove adjustment device (104-106). Before installation coat threads of thrust piece (104) and cylindrical portion of adjustment wheel (105) with prescribed lubricant Molykote paste U, Molykote paste G Rapid or Liqui-Moly paste 36. Assemble adjustment device and press all the way back. Hook in return spring (112).
Bolt (114)	press out of spreading lock (109) and remove spreading lock from brake control cable (86). Before installation coat all bearings and sliding surfaces on the spreading lock with prescribed lubricant, Molykote paste U, Molykote paste G Rapid or Liqui-Moly paste 36. Fasten brake control cable (86) with bolt (114) on spreading lock (109). Then press spreading lock toward cover ring (102).
Parking brake	adjust after installation of brake shoes and brake discs (42-0540).

42-0530 R and R parking brake shoes

Data	mm
Brake shoe dia.	160-0,2
Brake disc ID	160 + 0.2
Brake shoe width	25

Lubricant

Molykote paste U	Molykote paste G Rapid	Liqui-Moly paste 36
------------------	------------------------	---------------------

Special tools

