

33-500 R and R upper control arm

Tightening torques

Nm

Hex. bolt of upper control arm bearing to front end

80

Hex. nut of guide joint

40

Hex. bolt of upper control arm support to torsion bar

65

Special tool

Remover for guide joint

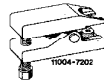

116 589 16 33 00

Self-made tool

Spacing plate

refer to illustration
item 9

Notes

Loosen hex. nuts on supporting and guide joint with the front spring installed only when the supporting jacks are resting against lower control arms instead of frame floor; if not, remove front spring.

Do not press off guide joint with front axle halves free of load, since this will damage rubber sleeve.

During assembly jobs, immediately replace damaged sleeves of supporting or guide joint.

Do not replace damaged or leaking sleeves on joints which have already been used. In such a case, always replace supporting joint or upper control arm.

The upper control arm bearing on front end, the upper control arm support on torsion bar, as well as the torsion bar bearing on front end may be tightened only when vehicle is in condition ready for driving. During assembly jobs, no preloads should occur on upper control arm via the torsion bar. If required, lift front axle half slightly at lower control arm on opposite side of vehicle.

Replace self-locking screws and nuts on principle!

33-500 R and R upper control arm

Removal

- 1 Jack-up vehicle at the front, place supporting jacks outside front against lower control arms, remove front wheel.
- 2 Loosen hex. nut of guide joint (8).

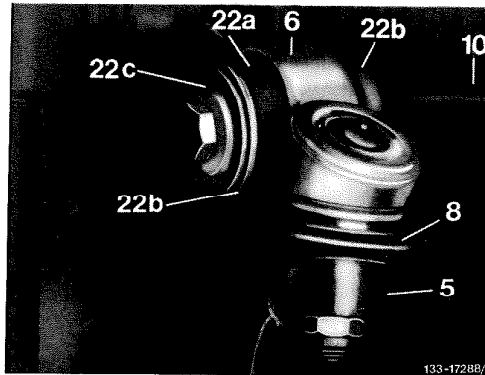

- 3 Remove guide joint from steering knuckle with respective tool.
- 4 Protect steering knuckle by means of a suitable hook at end stop of upper control arm against tilting.

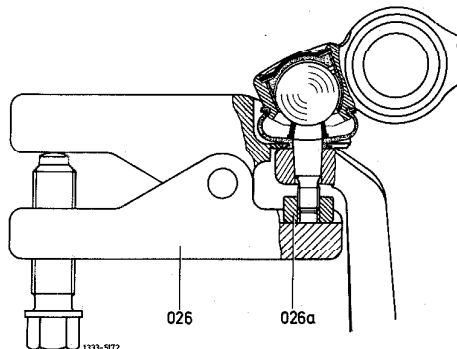

026 Remover
026a Thrust piece

- 5 Remove support of upper control arm.

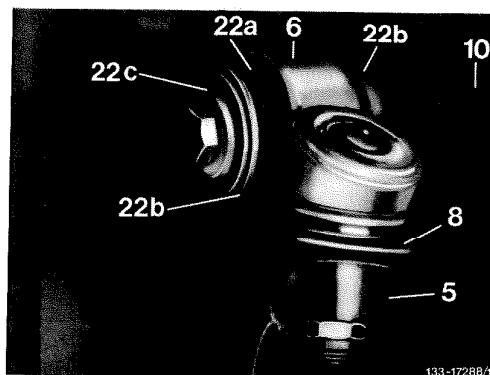

6 Upper control arm
8 Guide joint
10 Torsion bar
22a Rubber bearing
22b Disc washer
22c Cone washer

- 6 Loosen hex. screw (20) of upper control arm bearing at front end from direction of engine compartment, unscrew and remove upper control arm.

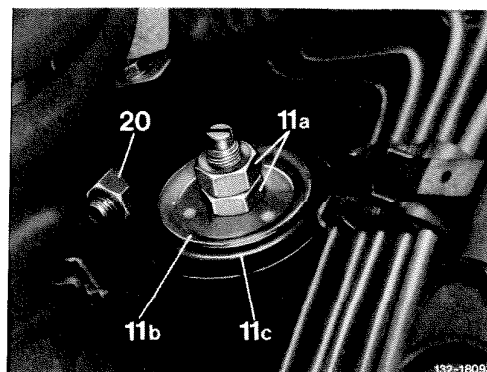

33-500 R and R upper control arm

Installation

7 Check guide joint in upper control arm (33-425).
Check rubber bearing.

8 Attach upper control arm to front end.

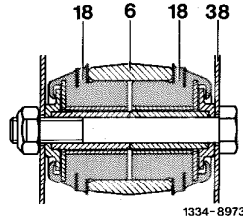

- 6 Upper control arm
- 18 Rubber slide bearing
- 38 Front end

1334-8973

9 Connect guide joint (8) with steering knuckle (5).

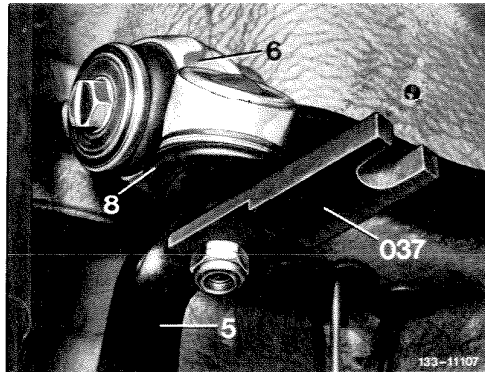

- 5 Steering knuckle
- 6 Upper control arm
- 8 Guide joint
- 037 Spacing plate

133-11107

Attention!

Use new self-locking hex. nut. Keep cone of ball pin and seat in steering knuckle free of grease.

If ball pin moves along on guide joint when tightening hex. nut, insert spacing plate and draw cone of ball pin into steering knuckle by tightening hex. nut. Then loosen hex. nut, remove spacing plate and tighten hex. nut to specified torque.

The spacing plate can be self-made.

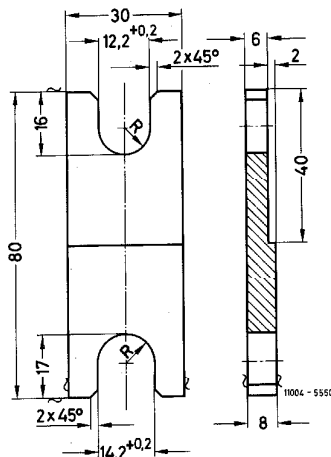

10 Mount support of upper control arm to torsion bar.

6 Upper control arm
10 Torsion bar
22a Rubber bearing
22b Disc washer
22c Cone washer

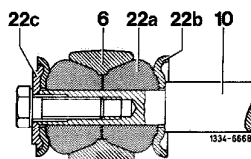

11 Mount front wheel, lower vehicle.

12 Check adjustment of front wheels (40-320).

13 Check adjustment of headlamps.