

Rear axle center assembly dia. 210 in MODEL 163.113 /128 /136 /154 /157 /172 /174 /175

- 40 Hexagon nut with collar
 40b Locking plate
 41 Joint flange
 42 Radial sealing ring
 106 rear propeller shaft

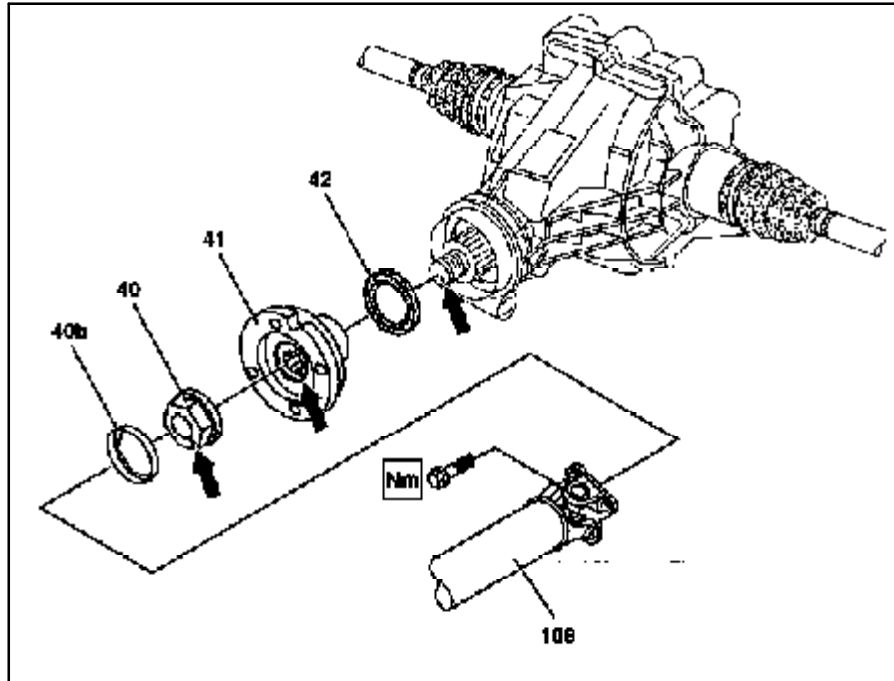

P35.31-0472-06

e d	Remove/Install		
1	Detach rear propeller shaft assembly (106) from rear axle center assembly.	i Support propeller shaft.	*BA41.10-P-1002-01C
2	Measure and note friction torque	n o l Torque meter	AR35.31-P-0530-04GH *001589492100
3	Mark hexagon collar nut (40) relative to drive pinion and joint flange (41) (arrows)		
4	Unscrew hexagon collar nut (40) and remove locking plate (40b)	i Installation: If the joint flange (41) is not replaced: ↓ Tighten the hexagon collar nut (40) up to the marking. If the joint flange (41) is replaced: ↓ Tighten hexagon collar nut in stages until the previously measured friction torque is obtained. l Retainer wrench	AR35.31-P-0530-05GH *163589000700
5	Pull off joint flange (41)	i Check for damage and replace if necessary.	
6	Press out radial seal ring (42) g Universal hypoid gear oils (SAE 85 W-90)	Installation: Replace radial sealing ring and coat the lip with universal hypoid transmission oil. l Drift	AR35.31-P-0530-06GH BB00.40-P-0235-07A *163589001500
7	Install in the reverse order		
8	Check oil level in rear axle center assembly and correct if necessary		AR35.31-P-0520-03GH
		n j	*BA35.31-P-1002-02A *BF35.31-P-1001-01I

n Rear axle center assembly housing

Number	Designation	Model 163
BA35.31-P-1002-02A	Oil filler plug, rear axle center assembly	Nm 50

n Driveshaft

Number	Designation	Model 163
BA41.10-P-1002-01C	Self-locking hexagon bolt of rear propeller shaft to rear axle center assembly	Nm 50

j Rear final-drive unit

Number	Designation	Model 163
BF35.31-P-1001-01I	Filling capacity Rear axle center assembly	Liters 1,65
	Specifications for Operating Fluids	Sheet BB00.40-P-0235-07A

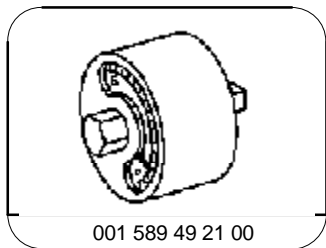

Torque measuring instrument

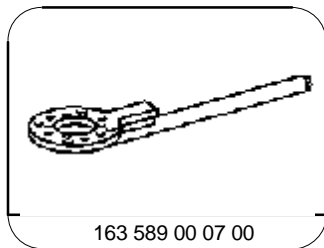

Retaining wrench

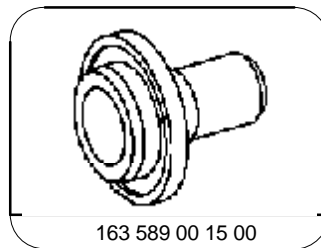

Drift