

MODEL 202

- 1 Cover
- 2 Edge protector
- 3 Screw
- 4 Panel
- 5 Plug
- 6 Screw
- 7 Handle
- 8 Hood release cable
- 9 Screw
- 10 Screw
- 11 Clip
- 12 Clip
- 13 Cover

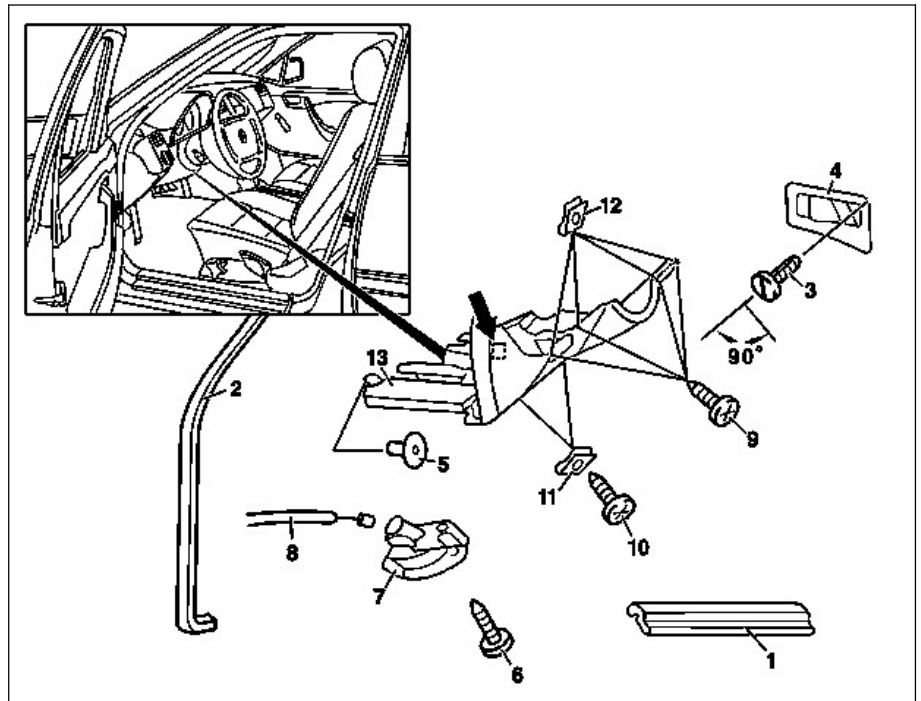

P68.10-0204-06

↕ ↘	Removal, installation		
1	Pull cover (1) off of side member		
2	Pull off edge protector (2) in area of A-pillar		
3	Turn screw (3) 90° and pull out		
4	Remove panel (4)		
5	Unscrew plug (5)		
6	Unscrew screw (6)		
7	Remove handle (7) and unhook hood release cable (8)		
8	Lay handle (7) to one side		
9	Unscrew screws (9 and 10)		
10.1	Pull off release handle for steering column adjustment and remove screw for housing	Only on vehicles with manually adjustable steering column as special equipment (code 441)	
11	Remove cover (13)	⚠ When installing insert lug (arrow) into front of instrument panel	
12	Reinstall in opposite order		