

## ENGINE 120.980 /981

## Illustrated on model 140

- 1 Angle lever
- 2 Connecting rod
- 3 Connecting rod
- 6 Control transfer lever
- 7 Control pressure control cable transfer lever
- 11a Adjustment screw
- 24 Accelerator pedal
- 26 Driver spring
- 29 Adjustment nut
- 30 Control cable
- 32 Adjustment nut
- 98 Control pressure control cable
- M16/3 Electronic accelerator pedal actuator
- S16/7 Kick down switch

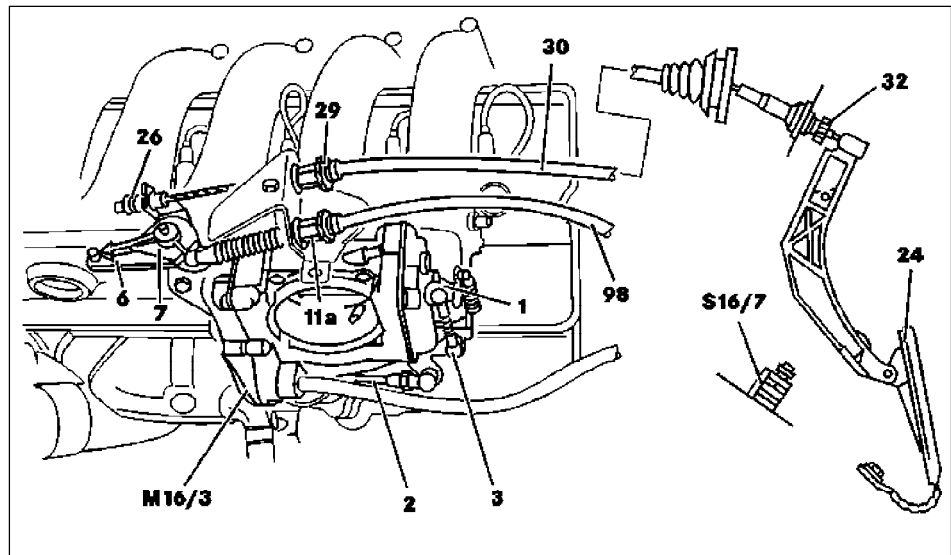

P30.10-0245-05

	Ignition: OFF		
1	Check connecting rods (2, 3) and control cable (30) for easy motion and good condition	Replace parts if required	*BE30.10-P-1001-01B *BE30.10-P-1002-01B
	<b>Idle adjustment</b>		
2	Check idle stop	The angle lever (1) should rest against the idle stop on the electronic accelerator pedal actuator (M16/3) (stop audible). Driver spring (26) should make contact with control cable without play. Adjust if necessary with adjustment screw (32)	
3	Adjust control pressure control cable (98)	For this purpose, the tips of the control transfer lever (6) and control pressure control cable transfer lever (7) must be positioned exactly opposite one another with the control pressure control cable hooked in. If necessary, adjust with adjustment screw (11a)	
	<b>Full throttle adjustment</b>		
4	Ignition: ON	The ignition must be switched on, otherwise, the throttle flap does not move to the full throttle position	
5	Press accelerator pedal (24) down to stop on kickdown switch (S16/7) from inside of car with engine shut off (do not actuate kickdown switch!)	The angle lever (1) should make contact with the full throttle stop on the electronic accelerator pedal actuator (M16/3) (audible stop), if necessary adjust with adjustment nut (29). If the control rod is actuated from the engine compartment with the ignition switched on, the electronic accelerator control module (N4/1) goes to the limp-home mode. To cancel the limp-home mode, switch off the ignition	
6	Ignition: OFF		
7	Accelerator pedal in idle position	If necessary, adjust driver spring (26) play with adjustment nut (32) from inside of car	*BE30.10-P-1003-01B
8	Lubricate control cable (30) between end elements and guide element with corrosion protection grease		*BR00.45-Z-1007-06A

## Test values for control

Number	Designation	Engines 120.980, 120.981
BE30.10-P-1001-01B	Length of connection rod to control transfer lever	mm 173
BE30.10-P-1002-01B	Length of connection rod to angle lever	mm 63
BE30.10-P-1003-01B	Control cable play between driver spring and guide on transfer lever	mm 0,5-1,0

**Service products for repair**

Number	Designation	Order no.
BR00.45-Z-1007-06A	Corrosion protection grease	001 989 37 51 10