

88-502 Removal and installation of push button lock, trunk lid lock and locking eye

Job number of the job texts and work units or standard texts and flat rates respectively

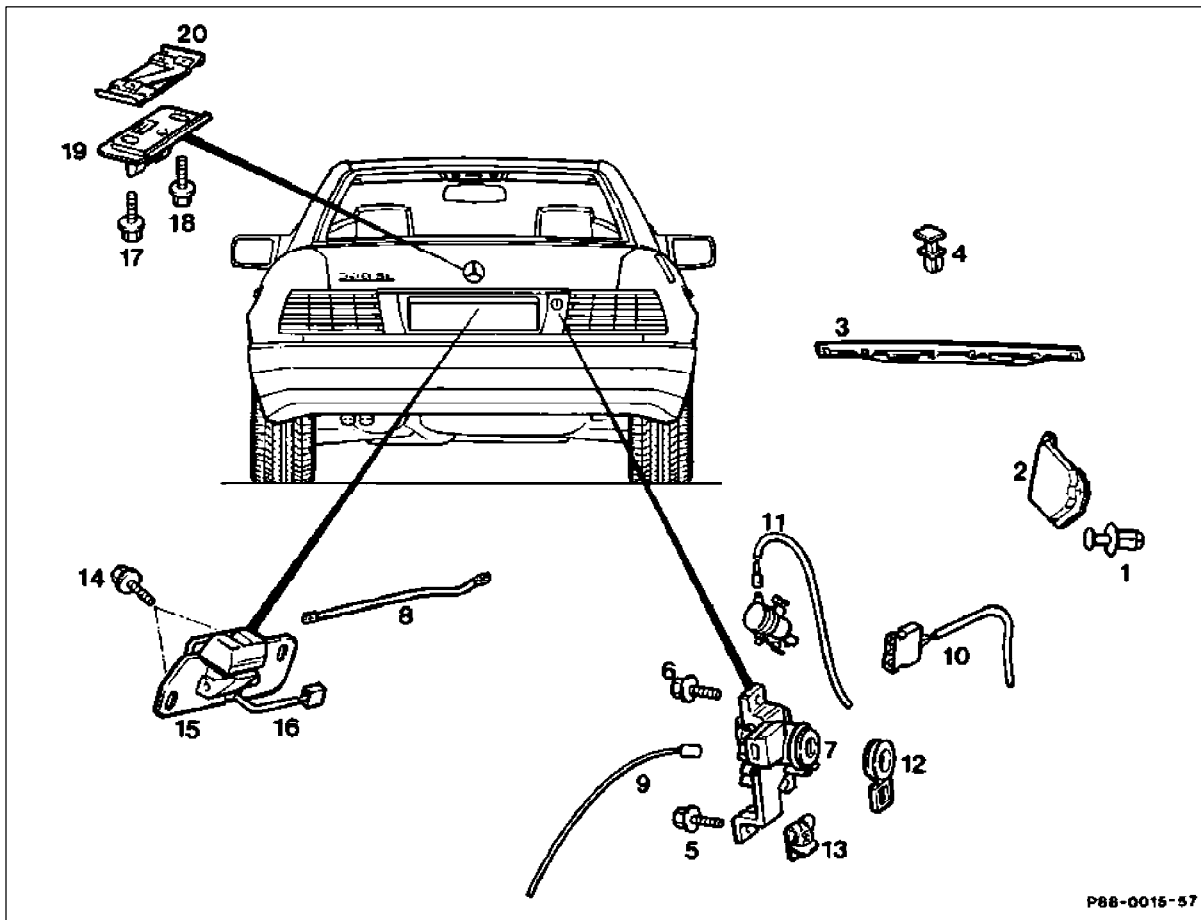

Push button lock

Plastic pin (1)

Cover (2)

Trunk light

Covering (3) on rear centerpiece

Screws (5 and 6)

Push button lock (7) on rear centerpiece

Plug connectors (9 and 10) on push button lock housing (7)

Vacuum line for central locking system on plug connector (11)

Push button lock (7)

remove.

remove.

remove.

remove, for this purpose remove pins (4, 6 each), and cover (3).

screw out.

remove, while extending linkage (8).

disconnect.

disconnect.

remove.

Trunk lid lock

Screw (14)

remove (2 each).

P88-0015-57

Trunk lid lock (15)

remove, while extending linkage (8) and disconnect
plug connector (16).

Locking eye

Screws (17 and 18) on trunk lid

screw out.

Locking eye (19)

remove.

Threaded plate (20)

remove.

Install in opposite order.

After installing the trunk lid lock or locking eye check
adjustment of trunk lid and correct, if required.